

# ERGÄNZUNGSPLAN

GEMEINDE: ST. WENDEL  
 GEMARKUNG: BLIESEN  
 FLUR: 09

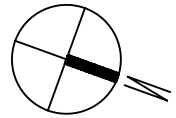

IM PUHL

ZUM AUGENBORN

MI2

MI2

MI1

SO

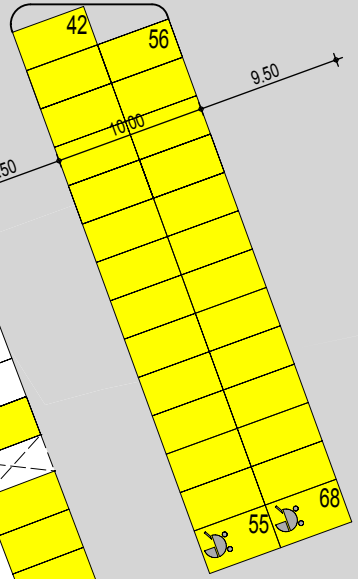
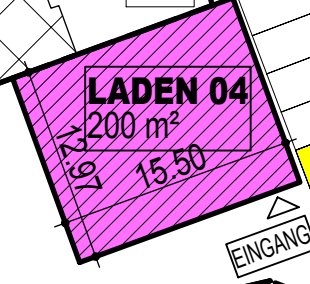
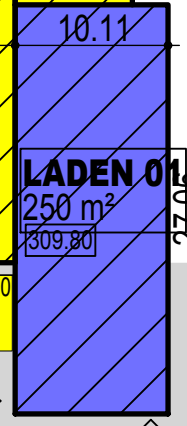
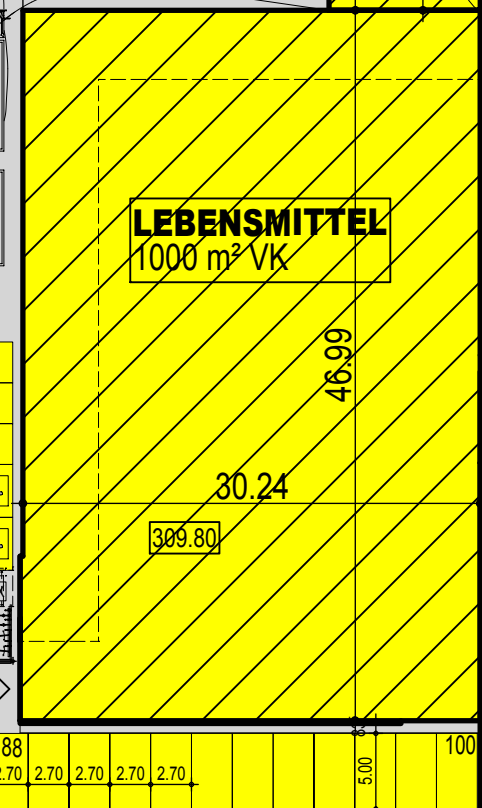
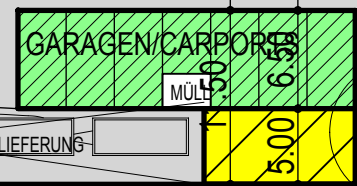
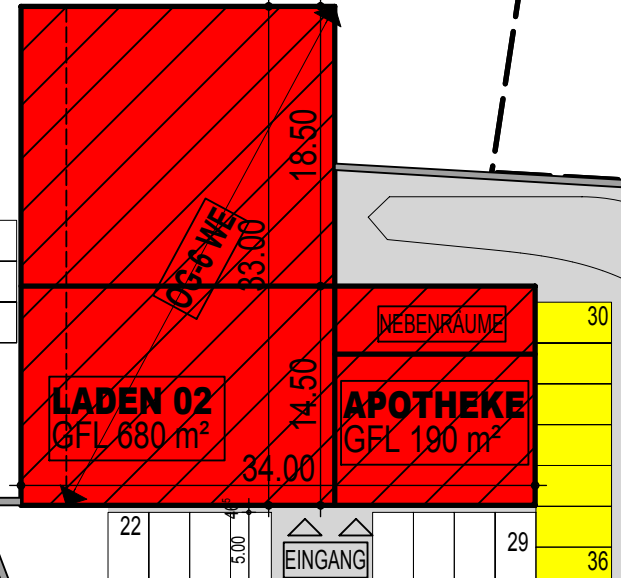
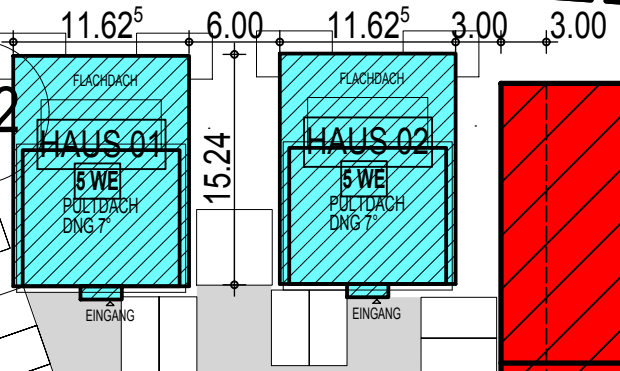

DIETMAR WEBER DIPL.ING.

HOFFMANN+WEBER GMBH+CO.KG ARCHITEKTEN-GEMEINSCHAFT

HETZELWIESSTRASSE 18 66578 SCHIFFWEILER

TEL: 06821 - 64522 FAX: 06821 - 692949

DETLEF HOFFMANN DIPL.ING.

ARCHITEKTEN-GEMEINSCHAFT HOFFMANN+WEBER GMBH+CO.KG

KIRCHSTRASSE L.I.O. 143

SCHIFFWEILER 29/07/2015